

GN 321

blank, rim polished

GN 323

black plastic coated

Disc handwheels

Aluminum

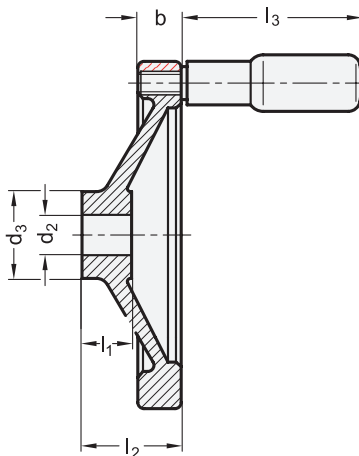
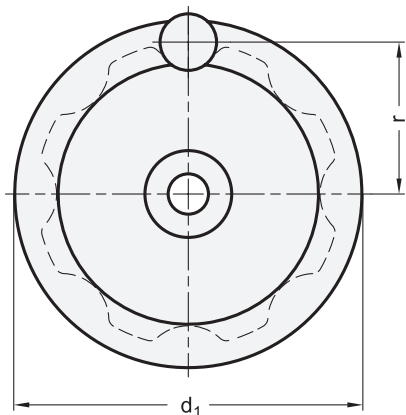
**2 Bore code**

- B** without keyway
- K** with keyway

4 Type

- A** without handle
- R** with revolving handle

1**3**

d ₁	d ₂ H7 Bore	d ₃	b	l ₁	l ₂ ≈	l ₃ ≈	r	Ø Handle GN 798	
80	10	12	26	13	16	26	44	33,5	16
100	10	12	28	14	17	30	58,5	42,5	18
125	12	14	31	15	18	33	61,5	54	22
140	14	16	36	16,5	19	36	76,5	61	24
160	14	16	36	18	20	39	76,5	71	24
200	18	20	45	20,5	24	45	86,5	89	25
250	22	26	48	23	28	51	86,5	113	25

Specification

- Aluminum
 - Hub machined
 - Rim turned
- Rim concentric and square to bore < 0,4
- **GN 321**
 - Rim high-polished
 - unmachined wheel body matt shot-blasted
- **GN 323**
 - Wheel body plastic coated
 - black, textured finish
- Revolving handles GN 798
Plastic, Technopolymer
black, matt
- Keyway P9 DIN 6885 → Page 1420
- Cross holes GN 110 → Page 1422
- ISO-Fundamental tolerances → Page 1479
- RoHS compliant

Information

Disc handwheels GN 321 / GN 323 have recessed grips at their back.

see also...

- Safety handwheels (disengage the clutch) → Page 204
- Countersunk washers GN 184 (for axial fixing) → Page 814
- Disc handwheels GN 923 (Aluminum, plastic coated) → Page 186

How to order (rim polished)

GN321-160-K16-A

- 1** d₁
- 2** Bore code
- 3** d₂
- 4** Type

How to order (plastic coated)

GN323-125-B12-R

- 1** d₁
- 2** Bore code
- 3** d₂
- 4** Type