



elesa

ELESA original design VRTP+IR-SST



Inox
Stainless
Steel



iF product
design
award

2 Bore code

- B** without keyway
- K** with keyway

4 Type

- R** with revolving handle

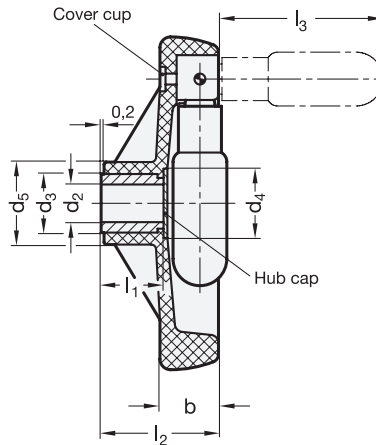
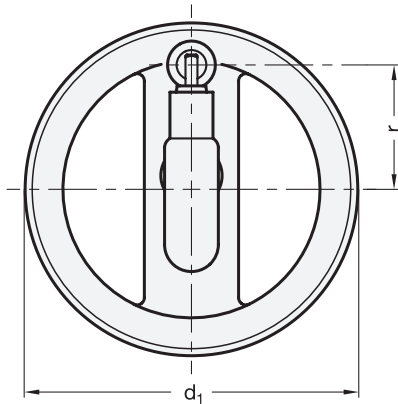

1

3

d ₁	d ₂ H7	d ₃	d ₄	d ₅	b	l ₁	l ₂	l ₃	r	Ø Umleggriff
80	8	18	20,5	25	18	17	35	45	29	15,5
100	10	18	20,5	25,5	20	17	37	60	37	18
125	12	22	26	31	22	22	44	65	48	22
160	14	26	31	40	25	27	51	73	65	24
200	16	30	36	48,5	28	34	61	80	84	24

Specification

- Plastic
Technopolymer (Polypropylene PP)
- reinforced, shock-resistant
- temperature resistant up to 80 °C
- black, matt
- Hub bushing
Stainless Steel AISI 304
- Hub cover
- Stainless Steel AISI 304
- self-adhesive
- Retractable handle
- Plastic, Technopolymer (Polyamide PA)
- black, matt
- certified in accordance with FDA
- Parts for retracting mechanism / spindle
Stainless Steel AISI 304
- Keyway P9 DIN 6885 → Page 1124
- Cross holes GN 110 → Page 1127
- ISO-Fundamental Tolerances → Page 1132
- Strength properties → Page 1138
- RoHS compliant

Information

Elegant design taking account of ergonomic and hygienic requirements are the outstanding features of the handwheels with retractable handle GN 522.6.

Owing to the materials used, they are especially suitable for use in corrosive atmospheres or in areas which must be wet cleaned. In particular, the FDA certified plastic materials allow the use in the food industry.

The handle in these handwheels is locked in the bore. To tilt, first pull the handle out of the cone in axial direction.

A pressure spring keeps the handle in both positions. When folding out, it will automatically engage again.

see also...

- Countersunk washers GN 184.5 (for axial fixing) → Page 542

Handwheel with retractable handle, bush St. Steel

GN 522.6-125-K12-R

1	d ₁
2	Bore code
3	d ₂
4	Form