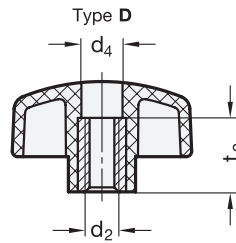
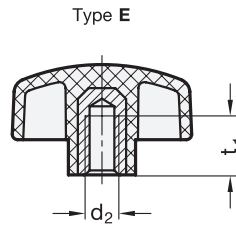
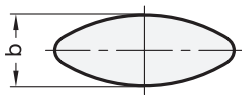
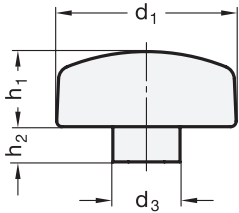

Range  
extended!

ELESA Original design CTL. 476

**3** Type

- E** with threaded blind bore  
**D** with threaded through bore

**1****2**

d <sub>1</sub>	d <sub>2</sub>		d <sub>3</sub>	d <sub>4</sub>	b	h <sub>1</sub>	h <sub>2</sub>	t <sub>1</sub> min.	t <sub>2</sub>
	Type E	Type D							
32	M 6	M 6	11	6,5	13	14,5	5,5	10	12
40	M 8	M 8	14	9	15,5	17	7,5	15	14
48	M 8	M 10	17	11	19	19	9	20	16
56	M 10	-	18,5	-	21	23	11	13	-

**Specification**

- Plastic  
Technopolymer (Polyamide PA)  
- glass fibre reinforced  
- temperature resistant up to 130 °C  
- black, matt finish
- Bush  
Brass
- Plastic characteristics → Page xx
- RoHS compliant

**Information**

see also...

- Wing nuts GN 532 (Hub not protruding) → Page xx
- Wing nuts GN 634 (Ergostyle®-Design) → Page xx

How to order

GN 532.1-48-M8-E

<b>1</b>	d <sub>1</sub>
<b>2</b>	d <sub>2</sub>
<b>3</b>	Type