

elesa

ELESA Original design VCT-B-LP/p-LP

**4 Type**

**E** with cap  
(threaded blind bore)

**5 Loss protection**

**P** with plastic ball chain

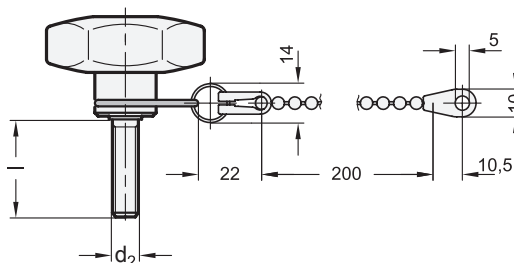

**1** **2** **3**

d <sub>1</sub>	d <sub>2</sub>	Length l				d <sub>3</sub>	h <sub>1</sub>	h <sub>2</sub>	h <sub>3</sub>	r	t
25	M 5	10	16	20	25	13	19	8	2,75	20	10
32	M 6	16	20	25	30	15	23	10	2,75	21	12
40	M 8	20	25	30	40	17	27	12	2,75	21,5	18
50	M 10	20	25	30	40	19	32	14	2,75	22,5	20
63	M 12	30	40	50	-	22	37	16	2,75	24	26

**Specification**

- Plastic  
Technopolymer (Polypropylen PP)  
- reinforced, shock resistant  
- temperature resistant up to 60 °C  
- black, matt
- Bushing  
Brass
- Threaded stud  
Steel zinc plated, blue passivated
- Retaining ring  
Technopolymer (Polypropylen PP)
- Ball chain  
Technopolymer (Polyoxymethylene POM)
- *Plastic characteristics* → Page XYZ
- **RoHS compliant**

**On request**

- Ball chain with other lengths

**Information**

Star knobs GN 5337.13 can be captively attached to a base element with the help of a bead chain.

The star knobs come installed (with a plastic bead chain).

see also...

- *Star knobs GN 6336.13* → Page XYZ
- *Star knobs with threaded stud GN 5337.2* → Page XYZ
- *More star knobs with loss protection GN 111.7* → Page XYZ

**How to order (Bushing)**

<b>1</b> d <sub>1</sub>
<b>2</b> d <sub>2</sub>
<b>3</b> <b>Type</b>
<b>4</b> <b>Loss protection</b>

**GN 5337.13-40-M8-E-P**

**How to order (Threaded stud)**

<b>1</b> d <sub>1</sub>
<b>2</b> d <sub>2</sub>
<b>3</b> <b>Length l</b>
<b>4</b> <b>Loss protection</b>

**GN 5337.13-50-M10-30-P**