

Type A

Type B

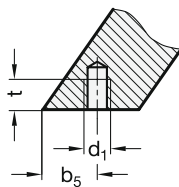

Socket button head screw

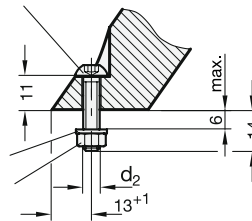

Washer
Hexagon nut

3 Type

- A Mounting from the back (threaded blind bore)
- B Mounting from the operator's side (only for b₁=26)

1 **2**

b ₁	Length l ±0,25	a	b ₂	b ₃	b ₄	b ₅ +1	d ₁	d ₂	h ₁	h ₂	r	t min.
20	112	13	24	32	50	13,5	M 6	-	32	48	13	10
20	128	13	24	32	50	13,5	M 6	-	32	48	13	10
26	128	17	32	34	57	18	M 8	M 6	34	54	17	12
26	160	17	32	34	57	18	M 8	M 6	34	54	17	12

Specification

- Aluminum
 - plastic coated
 - black, RAL 9005, textured finish
 - silver, RAL 9006, textured finish
 - anodized, natural color
 - blank
 - tumbled
 - Type B
 - Socket button head screws ISO 7380-M6-25
 - Hexagon nuts ISO 4032-M6
 - Washers DIN 125
- Steel, zinc plated, blue passivated
- Load rating information → Page 1456
 - RoHS compliant

- SW
- SR
- EL
- BL

Information

Inclined cabinet „U“ handles GN 565.2 are produced from profiled aluminum extrusions. Produced from profiled aluminum extrusions their special features are their rigidity and ergonomical shaping.

The angled contact surface allows improved access even in tight spaces such as corners.

The manufacturing process (bending) allows the production of **special lengths** in relatively small quantities.

For type B, socket button head screws, hexagon nuts and washers are included parts of the order.

see also...

- Cabinet „U“ handles GN 425.1 (angled) → Page 106 / 107
- Cabinet „U“ handles GN 426.1 (Aluminum, angled) → Page 114
- Cabinet „U“ handles GN 630.1 (Plastic) → Page 88
- Assembly sets for profile systems 30 / 40 GN 965 → Page 1428
- Assembly sets for profile systems 30 / 40 / 45 GN 968 → Page 1438

How to order	
1	b ₁
2	Length l
3	Type
4	Finish

GN 565.2-26-128-B-SW