

Range extended!

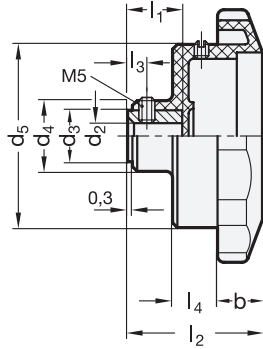

ELESA Original design VHT. GXX

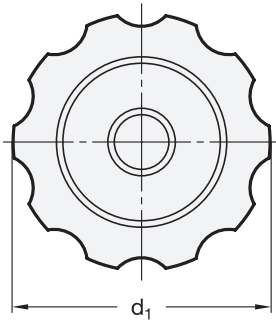

1

2

d ₁	d ₂ H7 Bore	d ₃	d ₄	d ₅	b	l ₁	l ₂	l ₃	l ₄	for position indicators	
										GN 000.8	GN 000.3
85	B 10	18	24	58	17,5	17,5	51	6	18	Size 42	-
110	B 12	22	28	77	20	22	58	6	18	Size 60	Size 60

Specification

- Plastic (Polyamide PA)
 - glass fibre reinforced
 - temperature resistant up to 100 °C
 - black, matt
- Bushing
 - Steel —
 - Stainless Steel NI
 - Steel blackened
 - Stainless Steel AISI 303
- Grub screw DIN 916 with internal hexagon and serrated point Steel resp. Stainless Steel AISI 304
- Grub screw DIN 916 with internal hexagon and serrated point
- ISO-Fundamental Tolerances → Page XYZ
- Stainless Steel characteristics → Page XYZ
- Plastic characteristics → Page XYZ
- RoHS compliant

Accessory

- Position indicators GN 000.8 / GN 000.3 are to be ordered separately

Information

Handwheels GN 577.8 have a recess in the hub to accept a position indicator GN 000.8 / GN 000.3.

For applications where these handwheels are by choice being used without the position indicators, a hub cap is available to cover the empty recess.

see also...

- Hub caps GN 576 → Page XYZ
- Position indicators GN 000.8 (Pendulum system, analogue indication) → Page XYZ
- Position indicators GN 000.3 (Pendulum system, digital/analogue indication) → Page XYZ
- Clamping elements GN 826 (for adjustable spindles) → Page XYZ

How to order

GN577.8-110-B12

1	d ₁
2	d ₂



Installation sequence

1. Install the handwheel to the spindle and fix it with the screw.
2. Turn the spindle to the starting point (0-position).
3. Move position indicator „by hand“ to the 0-position before mounting it.
4. Install the position indicator into the recess of the hub and fix it with a screw.
Do not apply unnecessarily excessive torque to avoid deformation of the housing!
5. Rotate the handwheel and ascertain that the starting point of the spindle is aligned with the 0-position of the two pointers (GN 000.8) respectively pointer and counter (GN 000.3).
Should that not be the case the screw has to be loosened and the position indicator adjusted. Tighten the screw again.