

3 Type

- E without thrust pad
- F with thrust pad DIN 6311

1 **2**

d ₁	l ₁			d ₂	d ₃	d ₄ h11	l ₂	l ₃	l ₄	l ₅ ≈	z ≈
M 6	40	50	-	12	5	4,5	10	50	10	2,2	5,4
M 8	50	60	-	14	6	6	12	60	15	3	6,8
M 10	60	70	-	18	8	8	14	80	20	3,6	8,2
M 12	70	80	-	20	10	8	18	100	20	4,5	8,6
M 16	75	90	110	24	12	12	20	120	20	5,3	10,6
M 20	75	90	110	30	16	15,5	28	140	20	5,6	12,4

Specification

- Steel
Tensile strength class 5
- blackened
- Thrust point hardened
- Thrust pads DIN 6311 → Page 794
- ISO-Fundamental tolerances → Page 1479
- RoHS compliant

Information

The thrust point of these screws DIN 6304 is designed to be used with or without a thrust pad for clamping.

The snap ring is a simple and quick method to connect the thrust pad to the tommy screw.

Instead of DIN 6311 a thrust pad GN 6311.1 can be used. In that case the tommy screw and the thrust pad have to be ordered separately.

see also...

- Thrust pads GN 6311.1 → Page 795

Hint for installation (Type F)

The thrust pad has to be held at an angle allowing the circlip to drop to the bottom of its groove with the split end downwards. The thrust point is then offered up to the split end of the circlip at the lowest possible angle and pressed home.

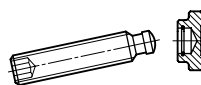

How to order

DIN 6304-M12-70-E

1	d ₁
2	l ₁
3	Type