

Figure sequence **L**

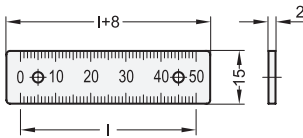

Figure sequence **M**

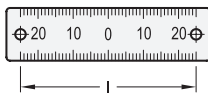

Figure sequence **R**

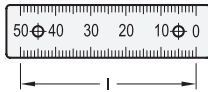

Figure sequence **U**



Figure sequence **M**



Figure sequence **O**

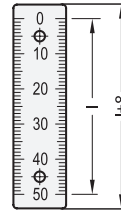

**3 Type**

**W** Figures horizontally arranged (Figure sequences L, M,R)

**S** Figures vertically arranged (Figure sequences U,M,O)

**5 Identification no.**

**1** with mounting holes  $\varnothing 3,3$

**Indicator arrow GN 711.3**

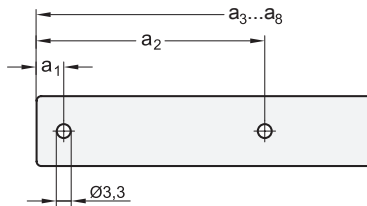
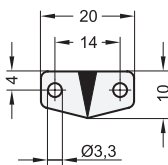

**2**

Length Scale	Number Bores	$a_1 \pm 0,1$		$a_2 \pm 0,1$		$a_3 \pm 0,1$		$a_4 \pm 0,1$		$a_5 \pm 0,1$		$a_6 \pm 0,1$		$a_7 \pm 0,1$		$a_8 \pm 0,1$	
		M	L/R O/U	M	L/R O/U	M	L/R O/U	M	L/R O/U	M	L/R O/U	M	L/R O/U	M	L/R O/U	M	L/R O/U
50	2	4	9	54	49	-	-	-	-	-	-	-	-	-	-	-	-
100	2	9	9	99	99	-	-	-	-	-	-	-	-	-	-	-	-
150	2	4	9	154	149	-	-	-	-	-	-	-	-	-	-	-	-
200	3	9	9	99	99	199	199	-	-	-	-	-	-	-	-	-	-
300	3	9	9	149	149	299	299	-	-	-	-	-	-	-	-	-	-
400	4	9	9	139	139	269	269	399	399	-	-	-	-	-	-	-	-
500	4	9	9	169	169	339	339	499	499	-	-	-	-	-	-	-	-
750*	8	4	9	124	129	254	249	374	369	394	389	504	509	634	629	754	749
1000*	8	9	9	169	169	339	329	499	499	519	519	679	679	839	839	999	999

\* These lengths consists of 2 parts.

**Specification**

**1**

- Aluminum **AL**
  - natural color anodized
  - black imprint with numbers and scale etched (i.e., Aluminum colored)
- Imprint resistant to weak acids and lye solutions, and against solvents in the event of brief contact
- RoHS compliant

**On request**

- self-adhesive version

**How to order (Ruler)**

**GN 711.2-AL-100-W-L-1**

- 1** Material
- 2** Length l
- 3** Type
- 4** Figure sequence
- 5** Identification no.

**How to order (Indicator arrow)**

**GN 711.3-AL-1**

- 1** Material
- 5** Identification no.