

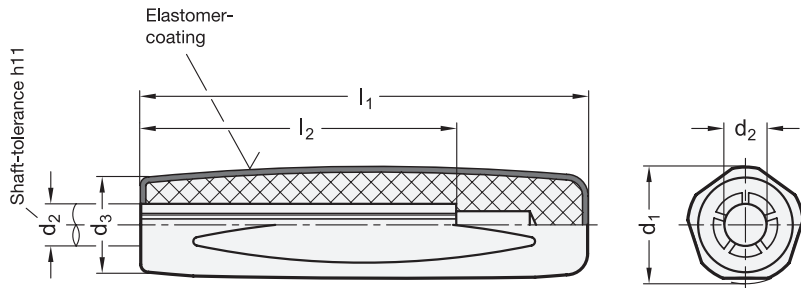



ELESA Original design EGH-SOFT



1

2

$d_1$	$d_2$ Bore B	$d_3$	$l_1$	$l_2$ min.
22	B 8	18	85	60

## Specification

- Technopolymer (Polypropylene PP)
  - coated with a soft elastomer (TPE) 70 Shore A
  - temperature resistant up to 80 °C
  - black, matte finish
- Softline-coating and plastic core chemically bonded
- *ISO-Fundamental Tolerances* → Page 1479
- *Elastomer characteristics* → Page 1483
- *Plastic characteristics* → Page 1483
- **RoHS compliant**

## Information

GN 819 Softline-Handles do not require a thread at the shaft.

During mounting, easy blows with a soft hammer are sufficient to drive the knob into place, the shaft end should be slightly rounded or chamfered (30°). The knobs sit absolute vibration-tight.

The semi-hard plastic material makes this handle very operator friendly.

see also...

- *Product family Ergostyle®* → Page 17
- *Product family Softline* → Page 17

How to order

GN 819-22-B8

1  $d_1$ 2  $d_2$