

# GN 87 Side mounting top brackets

Plastic

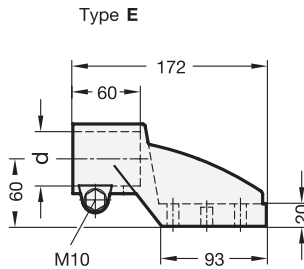

ELESA Original design TSLA / TSLB

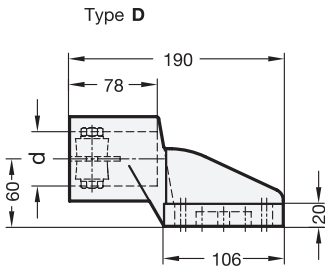

## 2 Type

- D** Fixing with 4 slotted holes
- E** Fixing with 2 bores

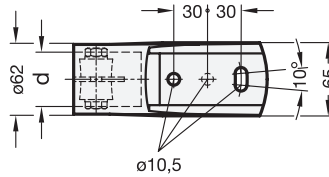
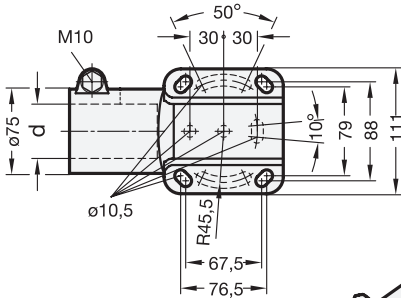

1

1

d	Bore B	Type D	Type E	for tube outside-Ø	standard description in inch
B 42,4	-			42,4	1 1/4"
B 48,3			B 48,3	48,3	1 1/2"
B 60,3	-			60,3	2"

## Specification

- Plastic (Polyamide PA)
  - glass fibre reinforced
  - temperature resistant up to 100 °C
  - black, matt
- Hexagon screws DIN 931  
Stainless Steel AISI 304
- Hexagon nuts DIN 934  
Stainless Steel AISI 304
- Washers  
Stainless Steel AISI 304
- *Stainless Steel characteristics* → Page XYZ
- *Plastic characteristics* → Page XYZ ff.
- **RoHS compliant**

## On request

- Type D with square 45 x 45

## Information

see also...

- *Base plate connector clamps GN 163 (Aluminium)* → Page XYZ
- *Construction tubes GN 990* → Page XYZ

How to order

GN 87-B60,3-D

1 d

2 Type

2.1

2.2

2.3

2.4

2.5

2.6

2.7

2.8

2.9